

YPR-50 Type PRESSURE REDUCING VALVE (FOR STEAM)



This model is a direct-operated pressure reducing valve for steam pipelines and various kind of steam facilities and widely used under the condition of a small flow field.

FEATURES

- This model is a direct-operated pressure reducing valve for a small flow field, in which pilot-type valves cannot control. This product shows superior performance in pressure control and has a wide range of adjustment, as especially the main contacting parts of this product are made of stainless steel thus shows high durability against corrosion and

SPECIFICATION

Applicable fluid	Steam
Applicable primary pressure	Max. 14kgf/cm ² g
Adjustable secondary pressure	0.2~1kgf/cm ² g(for low pressure), 1~2kgf/cm ² g(for medium pressure), 2~10kgf/cm ² g(for standard pressure)
Maximum reducing rate	10 : 1
Minimum differential pressure across the disc	0.5kgf/cm ²
Applicable temperature	220℃
Leakage Allowance	Less than 0.05% of rated flow
End connection	KS PT SCREW
Materials	Body : Cast iron Disc / seat : Stainless steel
Valve body pressure test	Hydraulic 21kgf/cm ² g

DIMENSIONS

Size	L	H1	H2	Weight (kg)
15(1/2")	110	54	180	5.5
20(3/4")	110	54	180	5.5
25(1")	144	66	256	8.6

DIMENSIONS

Valve inlet pressure (kgf/cm ² g)	Valve outlet pressure (kgf/cm ² g)	Size			Valve inlet pressure (kgf/cm ² g)	Valve outlet pressure (kgf/cm ² g)	Size		
		15(1/2")	20(3/4")	25(1")			15(1/2")	20(3/4")	25(1")
1	0.5	3.4	3.9	6.5	7	5.6	14.3	17	27.9
1.4	0.9	3.7	3.4	7.4		4.6	15.8	18.4	30.7
	0.5	3	3.9	4.4		2.8	13.9	16.2	26.4
2.1	1.6	4.4	5	7.9		0.7	4.8	5.6	9.3
	1	3.7	4.2	7.1	8.4	6.8	16.2	19.4	31.8
2.8	0.2	2.3	2.8	4.2		4.9	19.4	21.9	36.4
	2.3	7	8.5	13.2		3.2	16.9	18.8	31.6
	1.4	5.6	6.8	11.2		0.8	7.7	8.5	13.9
	0.3	2.8	3.9	5.4	10.6	8.4	20.2	23.4	38.7
3.5	2.8	9.1	10.1	17		6	25.6	29.6	50
	1.4	7	8.1	13.2		3.9	21	24.8	41.8
	0.4	3.4	4.4	6.2		1	9.3	11.6	17.9
4.2	3.4	9.6	10.8	18.6	12.7	9.8	28.7	34.1	55.8
	2.8	10.6	11.6	20.3		8.1	30.2	35.6	60.5
	1.3	6.3	7.3	12		4.9	27.1	30.2	52
	0.4	3.9	5.1	7		1.3	11.6	13.2	21.7
5.6	4.5	12.4	14.4	24	14	9.8	32.4	36.4	61.2
	3.8	13.1	15.8	24.8		8.1	33.3	38	63.6
	1.6	8.5	9.6	15.5		5.6	30.2	34.9	58.2
	0.6	4.2	5.4	7.6		1.4	14.7	17	27.1

CONSTRUCTIONS

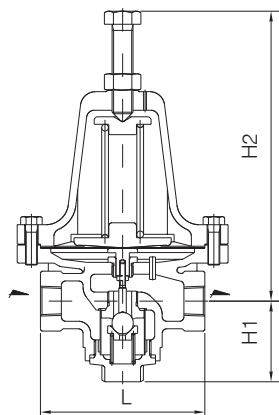

INSTALLATION EXAMPLE

