

# KY-4, 4N Type Strainer

Cast iron·Cast bronze Screwed

Y-shaped, screwed strainer made of cast iron or bronze, with compact body, large filtering area, is ideal to use in the pipeline where automatic valves are installed.

## SPECIFICATIONS

Body material	Cast iron		Cast bronze	
Model name	KY-4		KY-4N	
Code name	KY4-G2	KY4-G □	KY4N-J2	KY4N-J □
	※ 1, 3 or 4 for mesh is required in □.			
Size	15~65(1/2"~21/2")		15~50(1/2"~2")	
Applicable fluid	Steam, gases & liquids			
Applicable pressure	Max. 1.0MPa			
Applicable temperature	Max. 184℃*1.			
End connection	Screwed JIS Rc			
Materials	Body(Cast iron), Net(Stainless steel) Cover(Forged brass or cast iron)		Body, Cover(Cast bronze) Net(Stainless steel)	
Mesh	60 Mesh	※ 1:40 Mesh 3:80 Mesh 4:100 Mesh	60 Mesh	※ 1:40 Mesh 3:80 Mesh 4:100 Mesh
Pressure test	Hydraulic 1.5MPa		Hydraulic 1.75MPa	

\* 1. Applicable temperature Max. 220°C is available upon your request.

\* 2. Punched plate without lining is available. (Size 15~40mm: φ 1.3 P2.5. And size 50 and 65mm: φ 2.5 P4)

## DIMENSIONS

(mm)

Size	L	H	d	Mass(kg)
15(1/2")	75	55(53)	1/2"	0.6 (0.4)
20(3/4")	90	67(64)	3/4"	0.9 (0.6)
25(1")	110	78(77)	1"	1.4 (1)
32(1 1/4")	135	97(95)	1 1/4"	2.3 (1.7)
40(1 1/2")	150	112(109)	1 1/2"	3.5 (2.5)
50(2")	170	125(123)	2"	4.7 (3.7)
65(2 1/2")	200	145	2 1/2"	7.3

Figures in ( ) are for KY-4N Type.

## PRESSURE LOSS CHART (punch hole (punch plate))

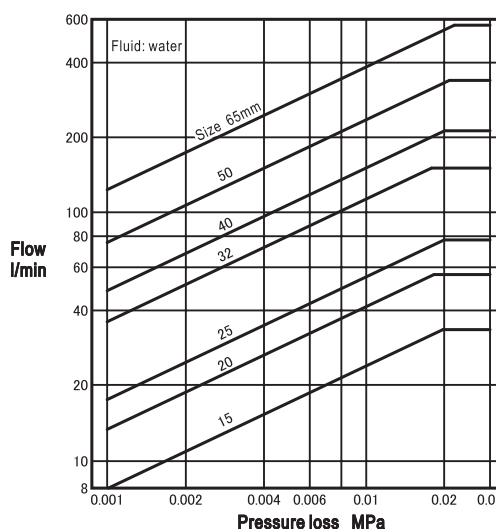

Note: The pressure loss for each mesh number can be calculated by multiplying pressure loss determined using the above chart and a multiplier listed below.

## MULTIPLIER LIST

Mesh	Multiplier
40	1.08
60	1.12
80	1.16
100	1.20

\* Refer to page 185 for mesh data.

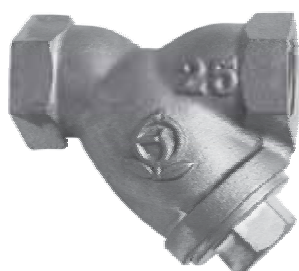

KY-4 Type

## CONSTRUCTION (KY-4 Type)

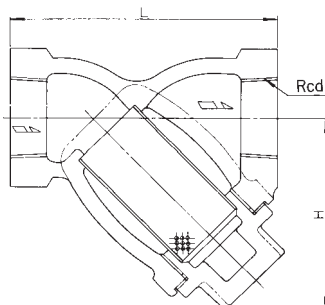

The structure of KY-4N is slightly different.

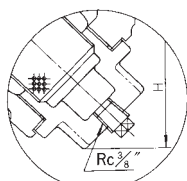

Size 50mm &amp; 65mm